

Adjustable rebated hinge - 19x8 for corner and vertical brackets



Description

Rebated hinge consisting of a support and an adjustable cold-pressed steel female part, with a self-lubricating plastic bushing. It can be adjusted horizontally (+4 mm or 6 mm) using a 5 mm Allen wrench.

Application

For rebated or overlapped shutters mounted directly on the wall or soffit, and frames flush with the exterior wall. The hinge, which is designed for both right and left-handed shutters, can be reversed by disconnecting the female body from the support and rotating it 180°.

- Used in combination with wall-mounted pintles (9 mm diameter pivot), pintles with plate, corner and vertical brackets. The combination

must be determined based on the shutter design.

- The **X** measurement must be determined keeping in mind that all the screws must be fastened to a load-bearing structure.

Mounting

We recommend the use of special theft-proof screws. Alternatively, you can use two 4.5 mm screws of appropriate length (matching the thickness of the shutter) and with thread suitable for the shutter material. Rivets can be used for PVCu and aluminium shutters. Use two 3.5x35 mm screws for lateral fastening to the shutter.

- For direct hinge attachment to the shutter (without brackets), use the compensating shim art. H00921.00.93.

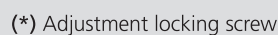

Seat available for hinge lock connection

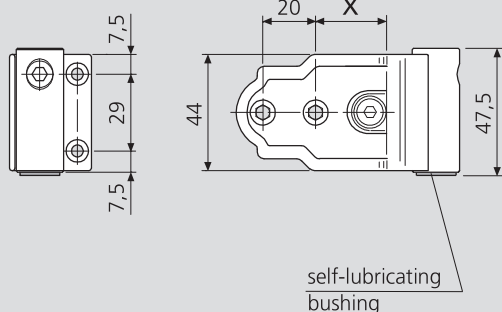
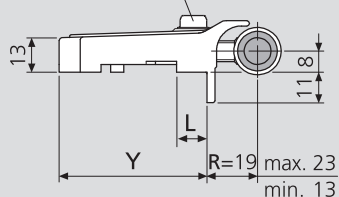

For **X** = 26 **Y** = 56 **L** = 11.5

For **X** = 35 **Y** = 63 **L** = 20.5

(*) Before adjusting the hinge, make sure the screw is not locked

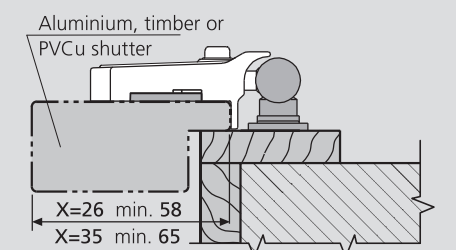

Drilling diagram **for soffit** viewed from the outside

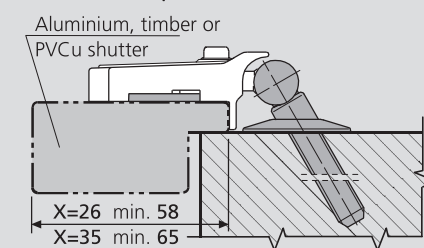
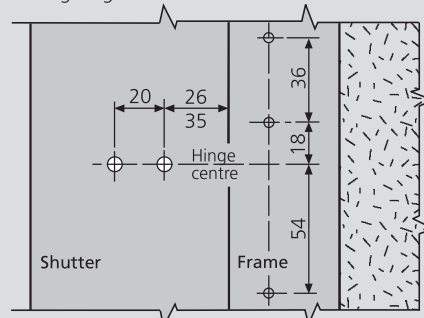

30° wall drilling diagram viewed from the outside

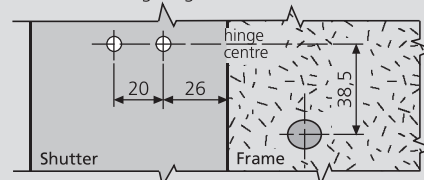

Order specifications

Order specifications		R			Black finish	Bichromated finish
Ref.	X	min.	centr.	max	Code	Code
R.-h.	26	13	19	23	H00932.08.93	H00932.08.04
L.-h.	26	13	19	23	H01932.08.93	H01932.08.04
R.-h.	35	13	19	23	H00944.08.93	H00944.08.04
L.-h.	35	13	19	23	H01944.08.93	H01944.08.04